

D'Andrea® Modular Tooling System for Rough and Finish Boring

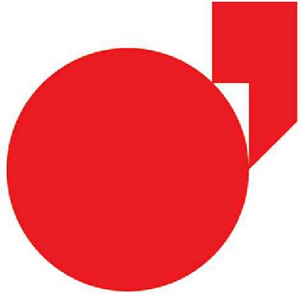

D'ANDREA®
TECHNOLOGY FOR HIGH PRECISION

**Your First Choice for Rough & Finish
Boring Applications from 1/4" to 39.0"**



**Promo Pricing
Valid until
July 31st, 2025!**



D'Andrea TRM Precision Boring Heads

TRM 16 ~ 125 INCH \varnothing .10 ~ 19.69

TRM 16 INCH	RPM 12.000
TRM 20 INCH	RPM 12.000
TRM 25 INCH	RPM 10.000
TRM 32 INCH	RPM 10.000
TRM 40 INCH	RPM 8.000
TRM 50 INCH	RPM 8.000
TRM 63 INCH	RPM 6.000
TRM 80 INCH	RPM 5.000
TRM 125 INCH	RPM 4.000

TRM heads allow high precision machining and excellent surface finish in IT6 grade of tolerance. The adjustment sensitivity of **.00004 μ m** on the radius is easily readable on the vernier scale and can also be performed in the machine.

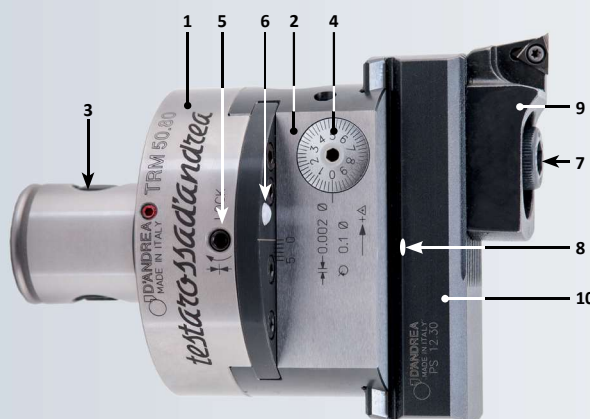
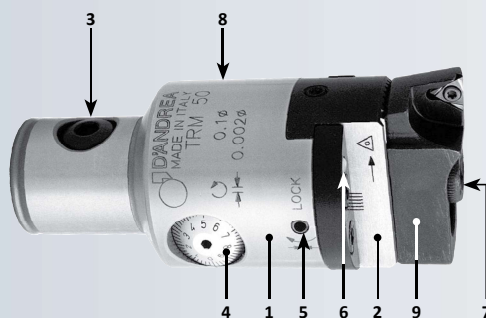

TESTAROSSA INCH

.00008 μ m



1. Body
2. Slide toolholder
3. Expanding radial pin
4. Micrometric vernier scale
5. Slide clamp screw
6. Coolant outlet
7. Tools clamp screws
8. Oiler
9. Bit holder
10. Tool holder

TRE 50 IP69K \varnothing .10 ~ 5.59

TRE 50 69K INCH	RPM 20.000
-----------------	------------

TRE heads allow high precision machining and excellent surface finish in IT6 grade of tolerance.

The adjustment of **.00004 μ m** on the radius is fast, accurate and easily readable on the integrated display.

The TRE 50 is resistant to infiltrations according to the IP69K grade.

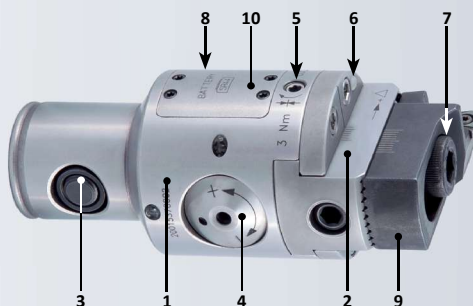

TESTAROSSA DIGITAL

.00008 μ m



1. Body
2. Slide toolholder
3. Expanding radial pin
4. Set screw
5. Slide clamp screw
6. Coolant outlet
7. Tools clamp screws
8. Oiler
9. Bit holder
10. Battery compartment cover
11. Digital display
12. Selection button

D'Andrea TRM Precision Boring Heads

TRM 16 \varnothing .71 ~ .91

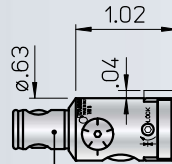

MHD'16

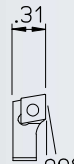

SFCC'16

TRM 20 \varnothing .87 ~ 1.14

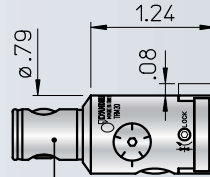

MHD'20



SFCC'20

TRM 25 \varnothing 1.10 ~ 1.50

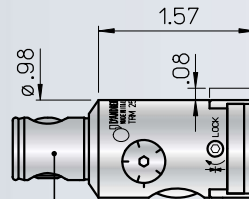
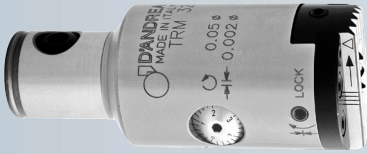

MHD'25

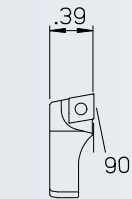

SFCC'25

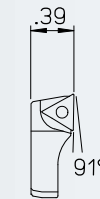

SFTP'25

TRM 32 \varnothing 1.40 ~ 2.03

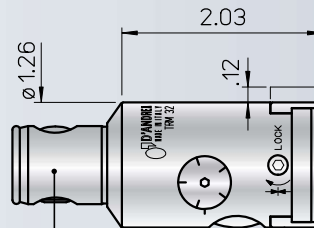

MHD'32

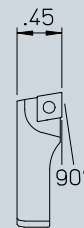

SFCC'32

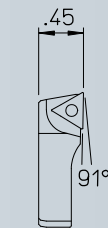

SFTP'32

TRM 40 \varnothing 1.89 ~ 2.48

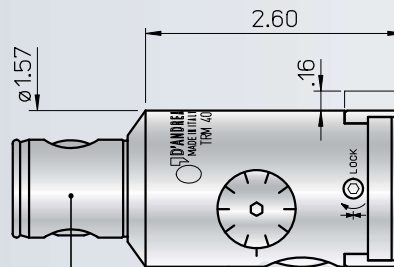

MHD'40



SFCC'40

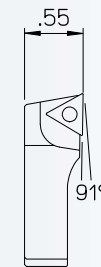

SFTP'40

TRM Precision Boring Heads

Boring Head	Range	Promo
TRM-16/16	.70" - .91"	\$730.89
TRM-20/20	.87" - 1.14"	\$785.03
TRM-25/25	1.10" - 1.50"	\$825.63
TRM-32/32	1.40" - 2.03"	\$866.23
TRM-40/40	1.89" - 2.48"	\$906.84

Boring Cartridges

Cartridge	Insert	Promo
SFCC-16	CCGT-0602....	\$98.81
SFCC-20		\$105.57
SFCC-25		\$108.28
SFCC-32		\$112.34
SFCC-40	CCGT-09T3....	\$117.76
SFTP-25	TPGX-0902....	\$108.28
SFTP-32		\$112.34
SFTP-40	TPGX-1103....	\$117.76

D'Andrea TRM Precision Boring Heads

TRM 50 \varnothing .10 ~ 5.51

TRE 50 IP69K \varnothing .10 ~ 5.59



.00008 μ m

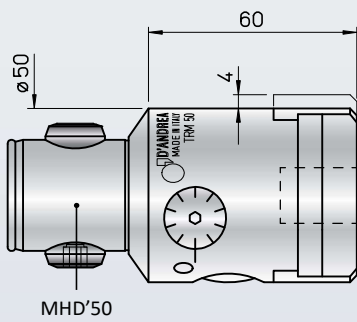

TRM 50
 \varnothing .10~5.51

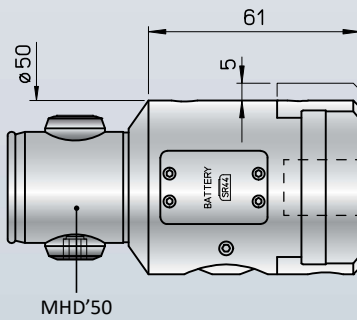

TRE 50 IP69K
 \varnothing .10~5.59

TRM Precision Boring Heads

Boring Head	Range	Promo
TRM-50/50	.10" - 5.51"	\$1,055.72
TR-E50/50-69K	.10" - 5.59"	\$2,436.29

Accessories

Part No	Description	Promo
D08.16	Bushing	\$110.85
P25.63	Cart. Extension	\$106.93
P25.105		\$158.36
PS-31.24	Slide	\$121.81
PS-32.24		\$135.35
CW32	Counter Weight	\$55.50

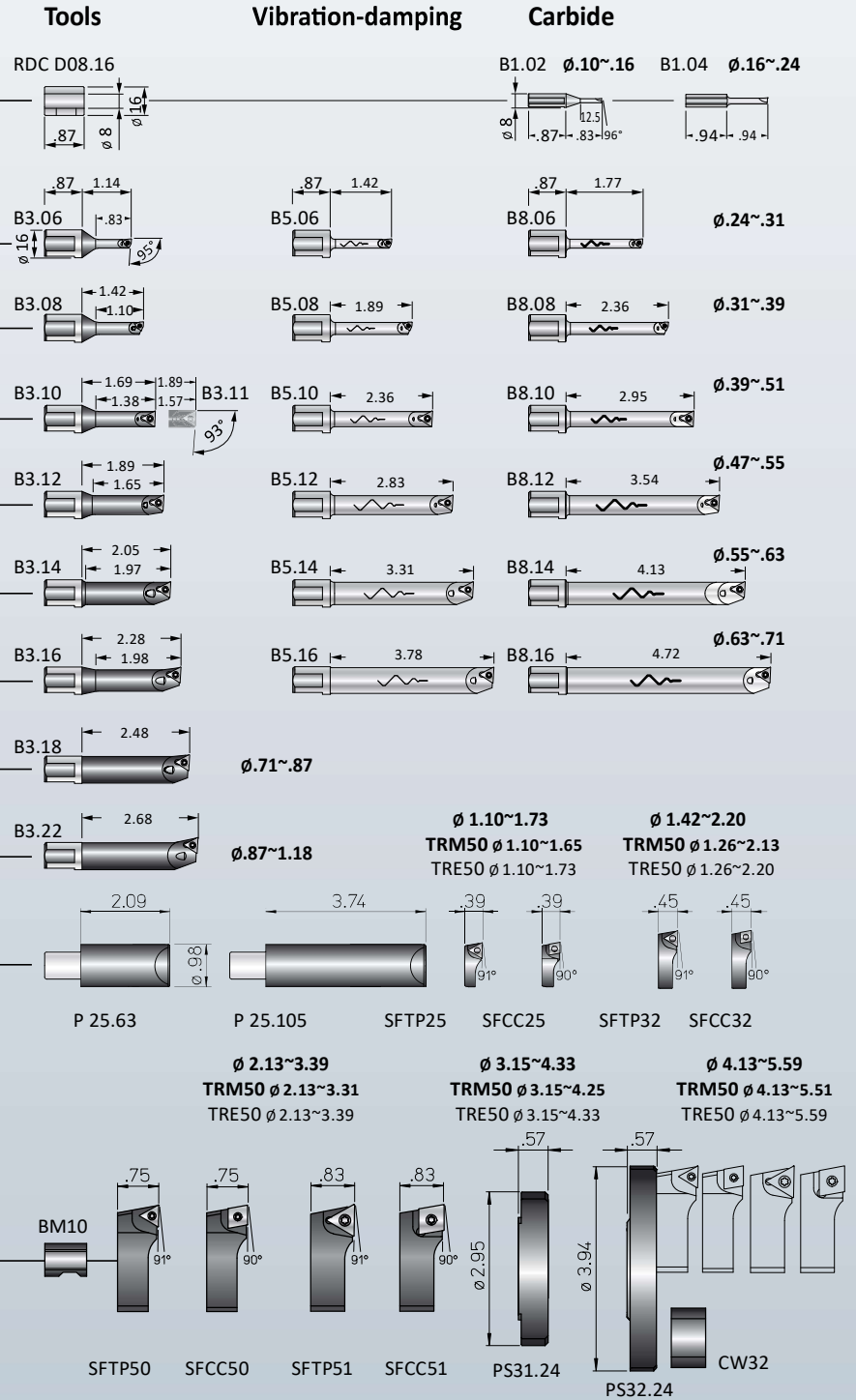

D'Andrea MHD-TRM Precision Boring Kits

Buy any Kit on this page, and Receive a FREE BT40/50 or CV40/50 or HSK-A63 Arbour!

KIT #: K01-TRM-50/50



**New Increased
Boring Range!**

Ø .236" - 5.51"

SALE!

\$2,279.95

Includes Free Arbour!

K01-TRM-50/50		
1pc. TRM-50	1pc. B3.06	1pc. SFTP-25
1pc. P25.63	1pc. B3.08	1pc. SFTP-32
1pc. PS31.24	1pc. B3.11	1pc. SFTP-50
1pc. PS32.24	1pc. B3.16	
1pc. CW32	1pc. B3.22	
5 pc. TPGX-090202L DC100		
1 pc. TPGX-110302L DC100		
2 pc. WCGT-020102L DC100		

KIT #: K01-TR-E50/50-69K Digital Head



The Kit **K01-TR-E50/50-69K Digital Boring Head** is fully digital and can be set up for either Inch or Metric read-outs. This head is water-proof to the 69K standards which include both dust and coolant sealing for many years of reliable service.

**New Increased
Boring Range!**

Ø .236" - 5.51"

SALE!

\$3,799.95

Includes Free Arbour!

K01-TR-E50/50	
1pc. TR-E50/50-69K	1pc. B3.06
1pc. SFTP-25	1pc. B3.08
1pc. SFTP-32	1pc. B3.11
1pc. SFTP-50	1pc. B3.16
1pc. P25.63	1pc. B3.22
PS-31.24	1pc. CW32
PS-32.24	
5 pc. TPGX-090202L DC100	
1 pc. TPGX-110302L DC100	
2 pc. WCGT-020102L DC100	

KIT K01 TRM 50/50

Working Range

KIT K01 TR-E50/50 - Digital

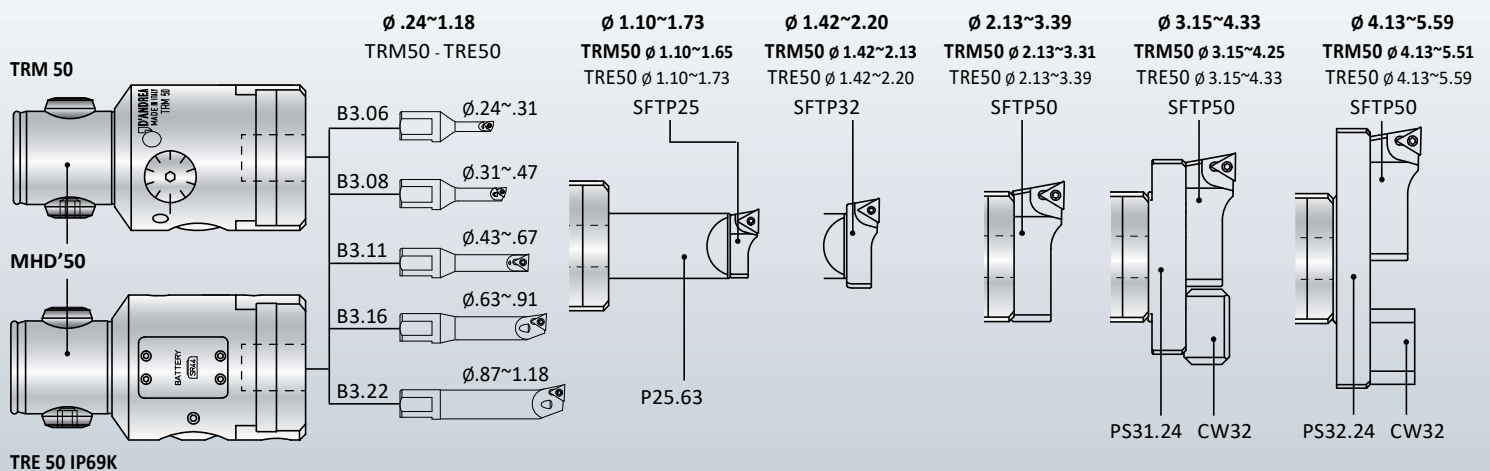

TRM 50/63 - TRM 63/63 $\phi .10 \sim 6.10$

TRM 50/80 - TRM 80/80 $\phi .10 \sim 8.66$



.00008 μ m

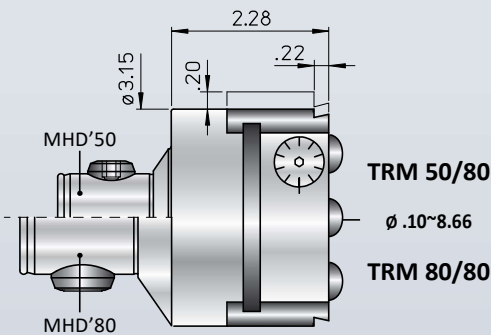
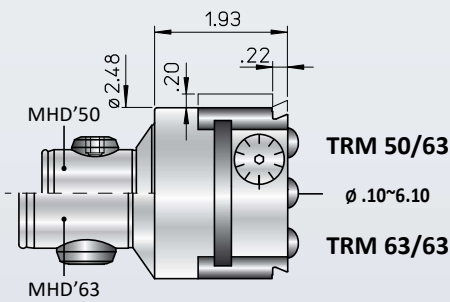

Tools

Vibration-damping

Carbide

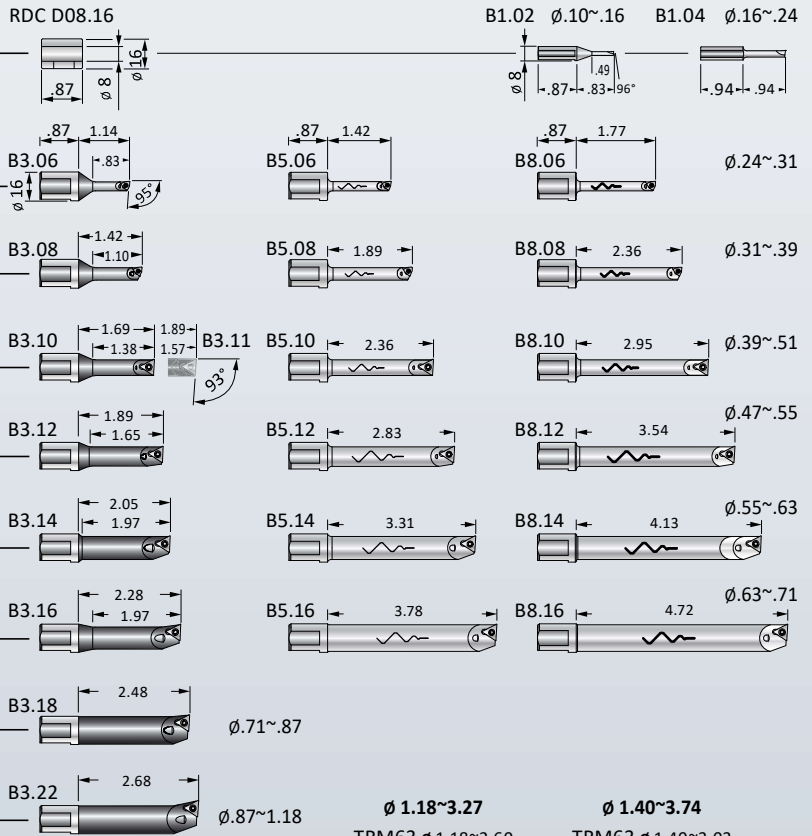

TRM Precision Boring Heads

Boring Head	Range	Promo
TRM 50/63	.10" - 6.10"	\$1,164.00
TRM 63/63		\$1,164.00
TRM 50/80	.10" - 8.66"	\$1,231.68
TRM 80/80		\$1,231.68

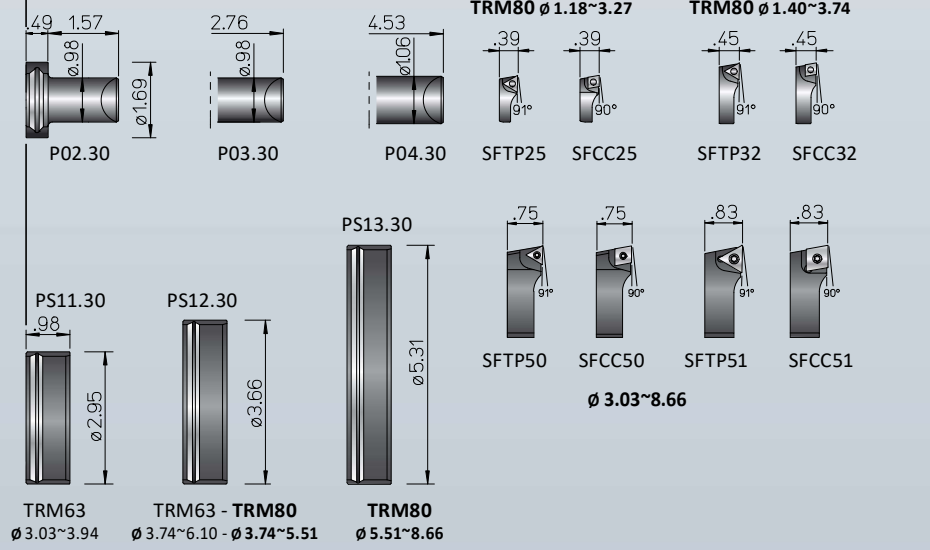

Accessories

Part No	Description	Promo
D08.16	Bushing	\$110.85
P-20.30	Bar Holder	\$116.40
P-02.30	Cart. Extension	\$120.46
P-03.30		\$131.29
P-04.30		\$192.20
PS-11.30	Slide	\$144.83
PS-12.30		\$157.01
PS-13.30		\$226.04

D'Andrea MHD-TRM Precision Boring Kits

Buy any Kit on this page & Receive a FREE BT40/50 or CV40/50 or HSK-A63 Arbour!

KIT #: K01-TRM-50/63 OR TRM-63/63



New Increased Boring Range!

Ø .236" - 6.10"

SALE!

\$2,669.95

Includes Free Arbour!

K01-TRM-50/63 or TRM-63/63		
1pc. TRM-50/63 or TRM-63/63		
1pc. PS11.30	1pc. B3.06	1pc. SFTP-25
1pc. PS12.30	1pc. B3.08	1pc. SFTP-32
1pc. P02.30	1pc. B3.11	1pc. SFTP-50
1pc. P03.30	1pc. B3.16	
1pc. P20.30	1pc. B3.22	
5 pc. TPGX-090202L DC100		
1 pc. TPGX-110302L DC100		
2 pc. WCGT-020102L DC100		

KIT K01 TRM 50/63 - 63/63

Working Range

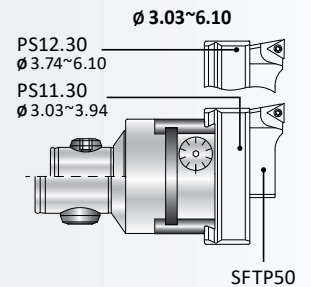
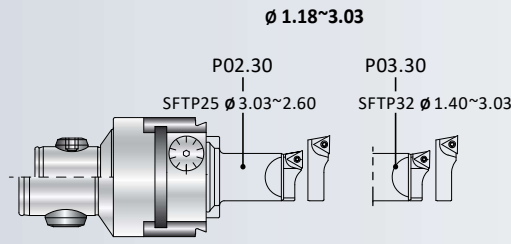
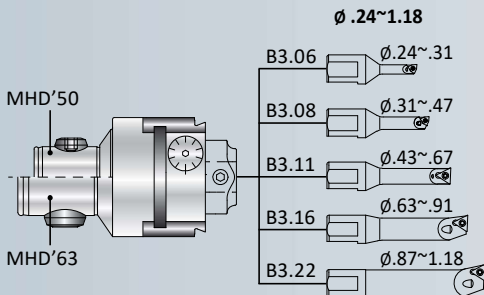

KIT #: K01-TRM-50/80 OR TRM-80/80



Boring Range:

Ø .236" - 8.67"

SALE!

\$2,999.95

Includes Free Arbour!

K01-TRM-50/80 or TRM-80/80		
1pc. TRM-50/80 or TRM-80/80		
1pc. P02.30	1pc. B3.06	1pc. SFTP-25
1pc. P03.30	1pc. B3.08	1pc. SFTP-32
1pc. P04.30	1pc. B3.11	1pc. SFTP-50
1pc. P20.30	1pc. B3.16	
1pc. PS12.30	1pc. B3.22	
1pc. PS13.30		
5 pc. TPGX-090202L DC100		
1 pc. TPGX-110302L DC100		
2 pc. WCGT-020102L DC100		

KIT K01 TRM 50/80 - 80/80

Working Range

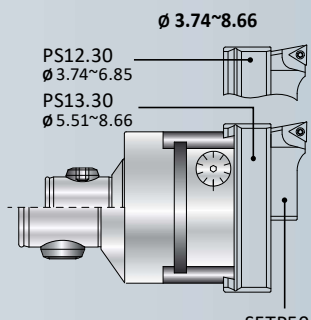
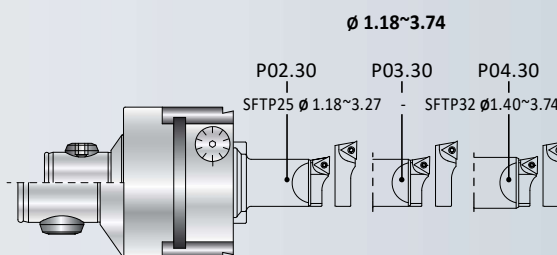
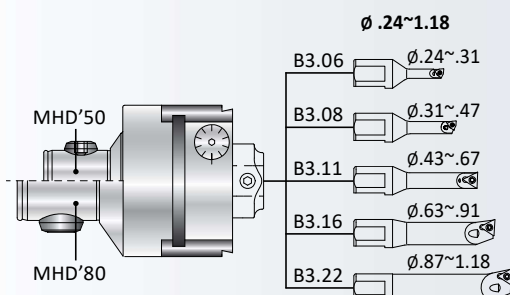

TRM 80/125 \varnothing 1.42 ~ 19.69

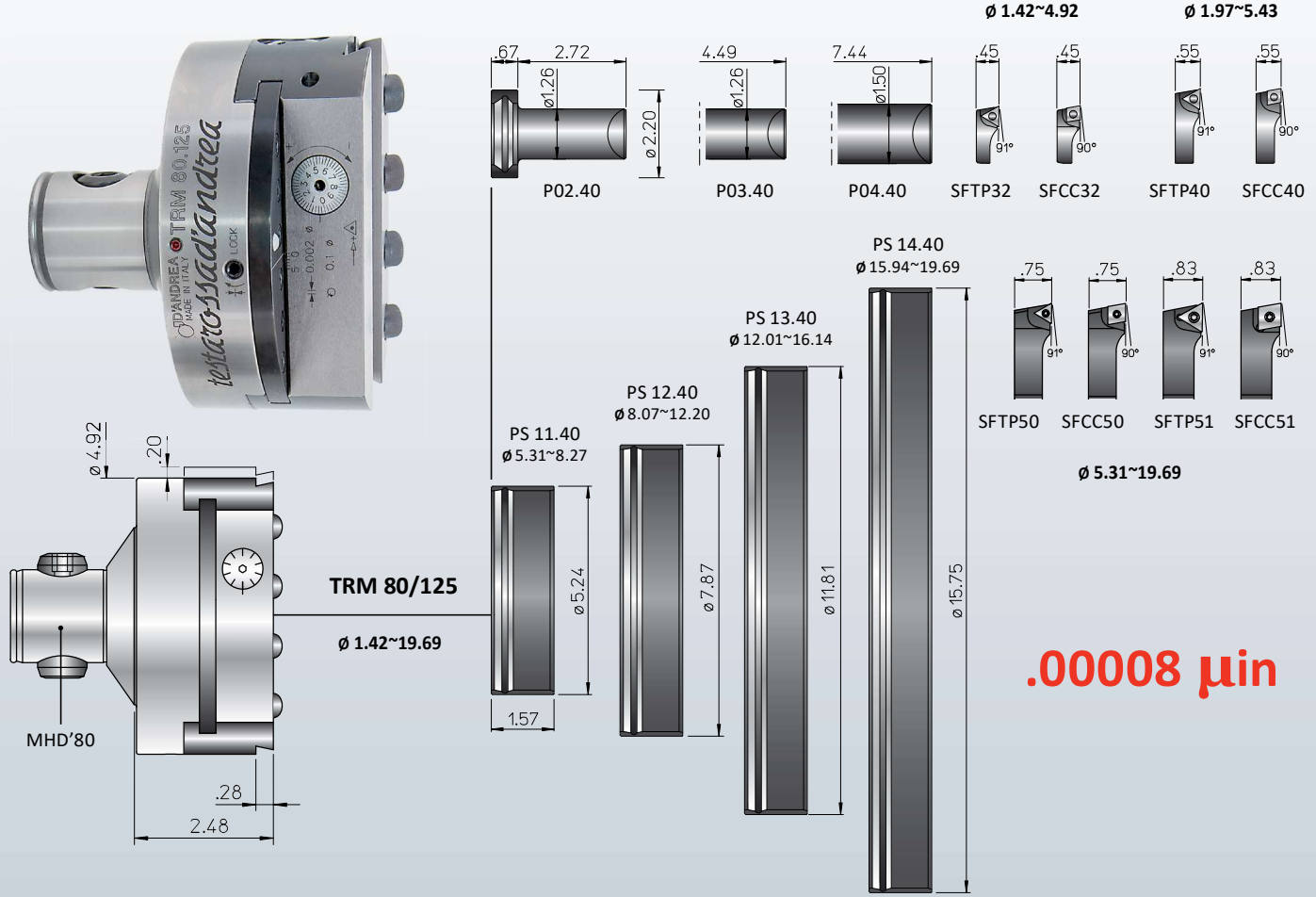

.00008 μ in

TRM Precision Boring Heads

Boring Head	Range	Promo
TRM 80/125	1.42" - 19.69"	\$2,070.84

Accessories

Part No.	Description	Promo
P02.40	Cart. Extension	\$163.78
P03.40		\$178.66
P04.40		\$263.93

Accessories

Part No.	Slide range	Promo
PS 11.40	5.31" - 8.27"	\$238.21
PS 12.40	8.07" - 12.20"	\$270.70
PS 13.40	12.01" - 16.14"	\$366.80
PS 14.40	15.94" - 19.69"	\$537.34

KIT #: K01-TRM-80/125

SALE!
\$3,999.95

Boring Range \varnothing 1.42" - 16.14"

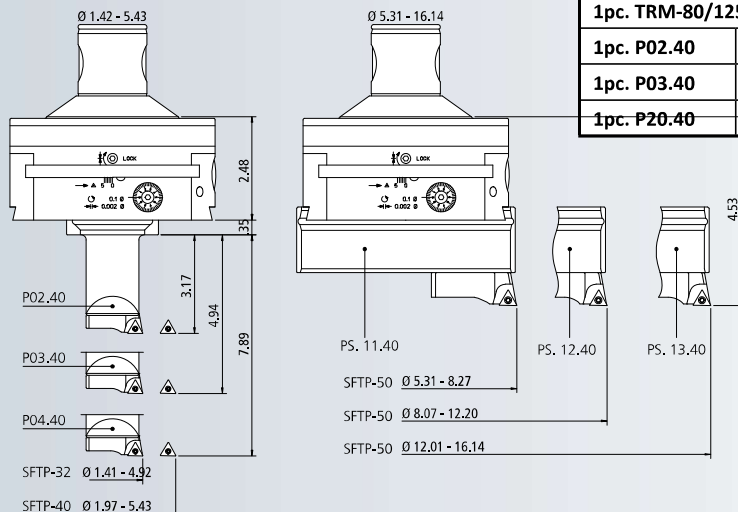

K01-TRM-80/125		
1pc. TRM-80/125		
1pc. P02.40	1pc. PS11.40	1pc. SFTP-35
1pc. P03.40	1pc. PS12.40	1pc. SFTP-40
1pc. P04.40	1pc. PS13.40	1pc. SFTP-50

**Includes
Free Arbour!**

Arbours for D'Andrea MHD Modular Tooling

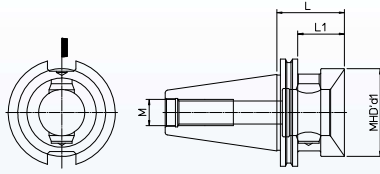

CAT V Flange

Taper	Item Code	MHD' d1	L	L1	Promo
CV-40	CV40-M50	M50	2.59	1.89	\$224.68
	CV40-M50L		4.72	3.98	\$291.00
	CV40-M63	M63	3.94	---	\$254.46
CV-50	CV50-M50	M50	1.89	1.14	\$291.00
	CV50-M50L		4.72	3.98	\$383.04
	CV50-M63	M63	2.20	1.16	\$291.00
	CV50-M63L		5.90	5.16	\$383.04
	CV50-M80	M80	2.44	1.69	\$355.97
	CV50-M80L		7.09	6.34	\$465.60

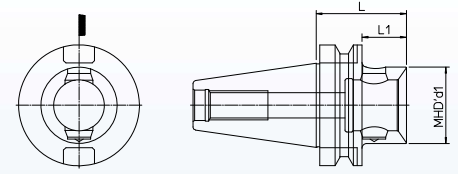

MAS403-BT

Taper	Item Code	MHD' d1	L	L1	Promo
BT30	BT30-M50	M50	2.36	---	\$217.92
BT40	BT40-M40	M40	1.77	0.71	\$213.85
	BT40-M50-48	M50	1.89	0.83	\$213.85
BT50	BT40-M63	M63	2.60	---	\$243.63
	BT50-M50	M50	2.60	1.10	\$277.47
	BT50-M63L	M63	2.95	1.46	\$277.47
	BT50-M80L	M80	2.95	1.46	\$339.73

CAT V Flange Face Contact

Taper	Item Code	MHD' d1	L	L1	Promo
CV-40	CV40FC-M50-2.60	M50	2.60	1.85	\$303.18
CV-50	CV50FC-M50-1.89	M50	1.89	1.14	\$374.26
	CV50FC-M63-2.20	M63	2.20	1.46	\$398.86
	CV50FC-M80-2.88	M80	2.44	1.69	\$413.11

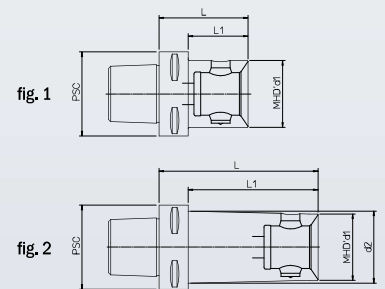
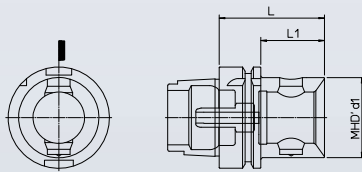

PSC Tapers

Taper	Item Code	MHD' d1	L	L1	Promo
PSC-50	PSC50-MHD50.55	M50	2.17	---	\$301.07
PSC-63	PSC63-MHD40.50	M40	1.97	1.10	\$306.64
	PSC63-MHD50.55	M50	2.17	1.30	\$306.64
	PSC63-MHD63.77	M63	3.03	---	\$341.49
PSC-80	PSC80-MHD50.60	M50	2.36	1.18	\$341.49
	PSC80-MHD63.70	M63	2.76	1.57	\$365.18
	PSC80-MHD80.75	M80	2.95	---	\$393.06

HSK "A" Form

Taper	Item Code	MHD' d1	L	L1	Promo
HSK-A50	HSK-A50-M50	M50	2.60	---	\$297.77
HSK-A63	HSK-A63-M40	M40	2.36	1.34	\$297.77
	HSK-A63-M40L		4.72	3.70	\$387.10
	HSK-A63-M50	M50	2.60	1.57	\$297.77
	HSK-A63-M50L		4.72	3.70	\$387.10
	HSK-A63-M63	M63	2.95	---	\$331.61
HSK-A80	HSK-A80-M50	M50	2.76	1.73	\$331.61
	HSK-A80-M63	M63	3.15	2.13	\$354.61
HSK-A100	HSK-A100-M50	M50	2.83	1.69	\$354.61
	HSK-A100-M50L		4.72	3.58	\$461.54
	HSK-A100-M63	M63	3.23	2.09	\$381.68
	HSK-A100-M63L		5.91	4.76	\$494.03
	HSK-A100-M80	M80	3.46	2.32	\$411.46
	HSK-A100-M80L		7.09	5.94	\$537.34

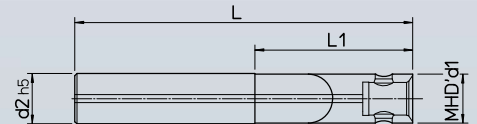

Metric Carbide Bars

Shank	Item Code	MHD' d1	d2 (MM)	L (MM)	Promo
16mm	BMD-16/16.110	M16	16	110	\$583.36
	BMD-16/16.140			140	\$706.52
	BMD-16/16.170			170	\$844.58
20mm	BMD-20/20.135	M20	20	135	\$798.56
	BMD-20/20.170			170	\$966.39
	BMD-20/20.210			210	\$1,166.71
25mm	BMD-25/25.160	M25	25	160	\$1,181.60
	BMD-25/25.205			205	\$1,457.71
	BMD-25/25.255			255	\$1,763.60
32mm	BMD-32/32.195	M32	32	195	\$1,840.75
	BMD-32/32.250			250	\$2,300.94
	BMD-32/32.315			315	\$2,838.28

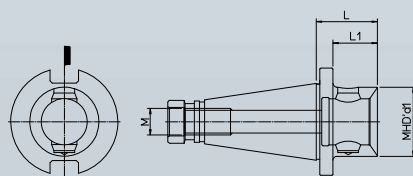

NMTB Tapers

Taper	Item Code	MHD' d1	L	L1	Promo
NMTB-40	NMTB40-M50	M50	1.89	1.44	\$224.68
NMTB-50	NMTB50-M50	M50	1.89	1.30	\$291.00
	NMTB50-M63	M63	2.20	1.61	\$291.00
	NMTB50-M80	M80	2.36	1.77	\$355.97

D'Andrea TS Double Cutter Boring Heads

TS 16 ~ 80 ϕ .71 ~ 9.84

Simple and extremely rigid roughing heads, thanks to the serrated surfaces between the head body and the bit holders. The constant distance between the bit holder clamping screw and the cutting edge guarantees the stability of the system.

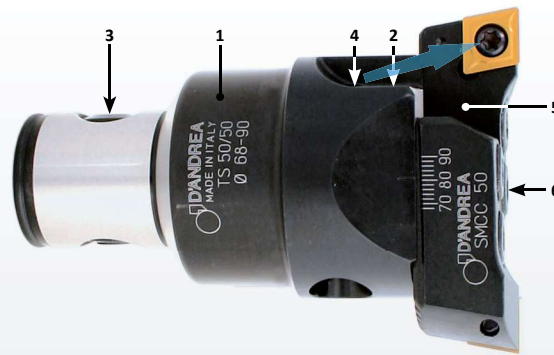

1. Body
2. Setting screws
3. Expanding pin
4. Coolant outlets
Max 580 PSI
5. Bit holders
6. Tools clamp screws

TS 16/16 ϕ .71 ~ .87

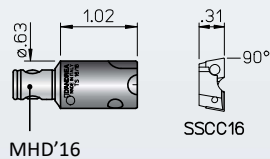

TS 40/40 ϕ 1.97 ~ 2.68

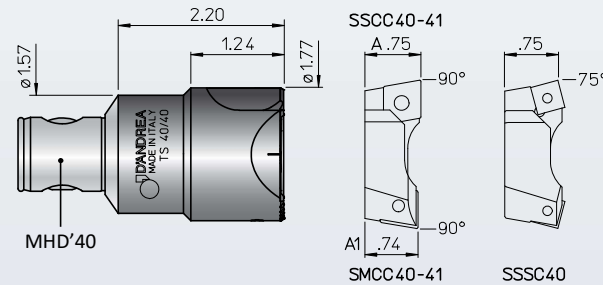

TS 20/20 ϕ .87 ~ 1.10

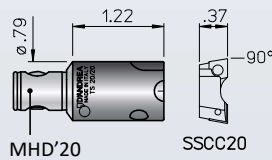

TS 50/50 ϕ 2.68 ~ 3.54

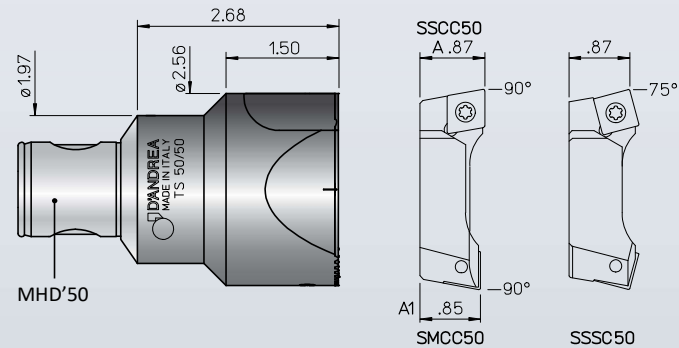

TS 25/25 ϕ 1.10 ~ 1.50

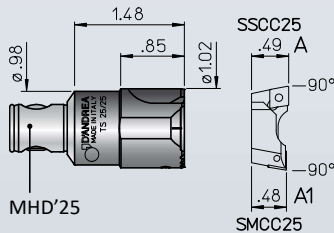

TS 50/63 - TS 63/63 ϕ 3.54 ~ 4.72

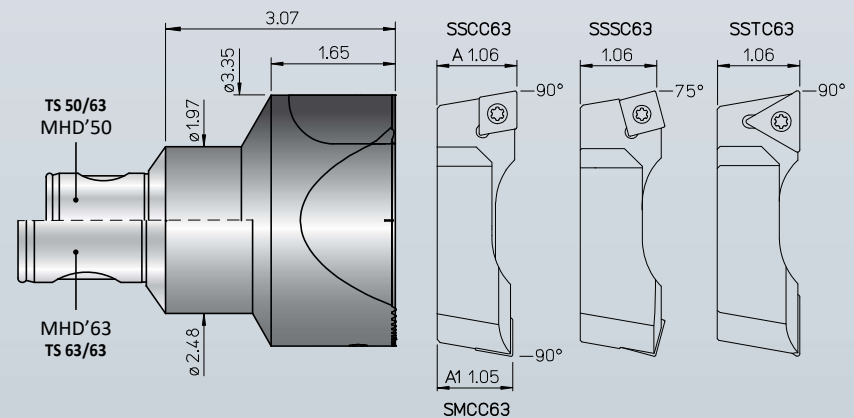

TS 32/32 ϕ 1.40 ~ 1.97

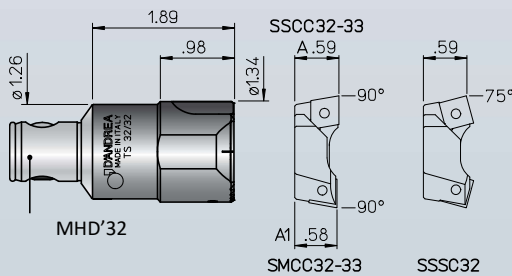

Double Cutter Roughing Heads

Code	Range	Promo
TS-16/16	.71" - .87"	\$270.70
TS-20/20	.87" - 1.10"	\$284.23
TS-25/25	1.10" - 1.50"	\$324.84
TS-32/32	1.40" - 1.97"	\$365.44
TS-40/40	1.97" - 2.68"	\$406.05

Code	Range	Promo
TS-50/50	2.68" - 3.54"	\$433.12
TS-50/63	3.54" - 4.72"	\$433.12
TS-63/63	3.54" - 4.72"	\$541.40
TS-80/80	4.72" - 7.87"	\$663.21
TS-80/90	6.30" - 9.84"	\$839.17

D'Andrea TS Double Cutter Boring Heads

TS 80/80 ϕ 4.72 ~ 7.87

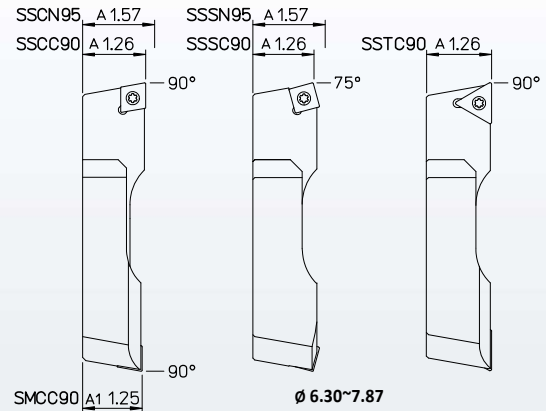
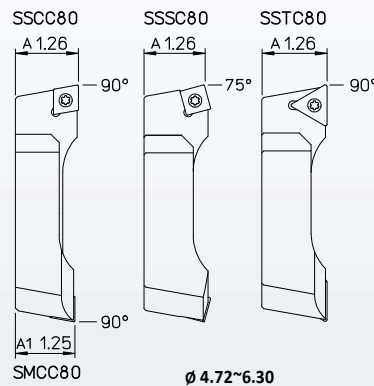
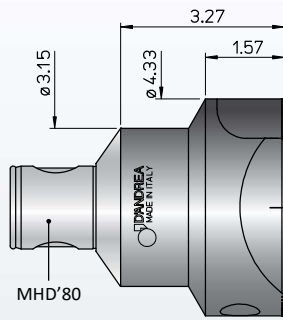

TS 80/90 ϕ 6.30 ~ 9.84

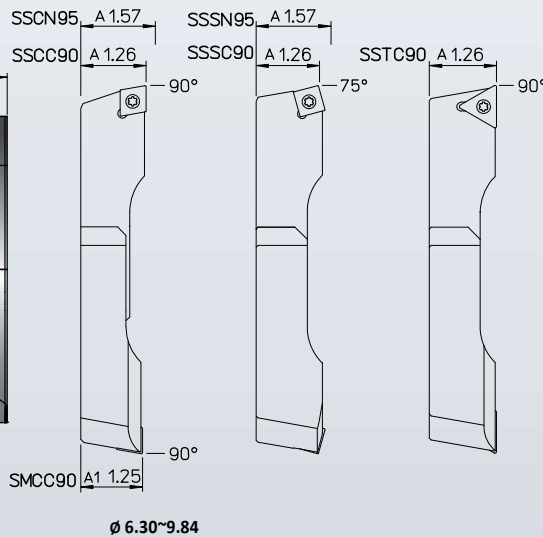
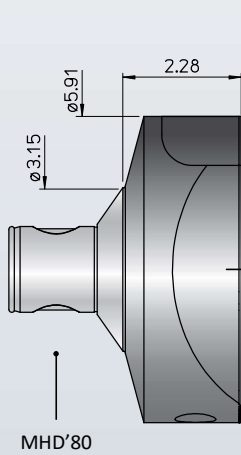

USE TS for ROUGHING end SEMI-FINISHING operations

Roughing and semi-finishing operations. Cutting edges might be adjusted on a pre-setting bench and TS heads can be used in three different configurations, with a single cutting edge (**pic. 3**) or misaligned ones (**pic.2**) half the feed.

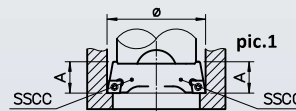

pic.1 with two SSCC bit holders aligned and on the same diameter for roughing operations with high feedrate.

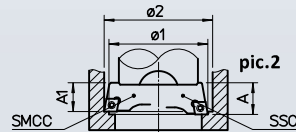

pic. 2 with one SSCC bit holder and one SMCC bit holder staggered and on a different diameter for roughing operations with high depth of cut.

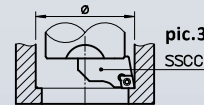

pic.3 with a single bit holder for roughing or semi-finishing operations.

Insert Cartridges for TS Double Cutter Boring Heads

Cartridge	Insert	Promo
SSCC 16	CCMT-0602....	\$98.81
SSCC 20		\$105.57
SSCC 25		\$108.28
SSCC 32		\$112.34
SSCC 33		\$112.34
SSCC 40	CCMT-09T3....	\$117.76
SSCC 41	CCMT-1204....	\$117.76
SSCC 50		\$120.46
SSCC 63		\$205.73
SSCC 80		\$234.16
SSCC 90		\$297.77
SSCN 95	CNM.-1906....	\$446.65
SSTC 63	TCMT-2204....	\$205.73
SSTC 80		\$234.16
SSTC 90		\$297.77

Cartridge	Insert	Promo
SMCC 25	CCMT-0602....	\$108.28
SMCC 32		\$112.34
SMCC 33		\$112.34
SMCC 40	CCMT-09T3....	\$117.76
SMCC 41	CCMT-1204....	\$117.76
SMCC 50		\$120.46
SMCC 63		\$205.73
SMCC 80	SCMT-09T3....	\$234.16
SMCC 90		\$297.99
SSSC 32		\$112.34
SSSC 40	SCMT-1204....	\$117.76
SSSC 50		\$120.46
SSSC 63		\$205.73
SSSC 80	SCMT-1204....	\$234.16
SSSC 90		\$297.77
SSSN 95	SNMM.-1906....	\$446.65

D'Andrea MHD Extensions and Reducers

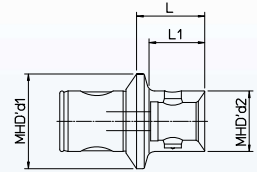
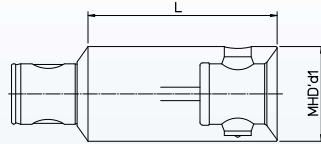

Extensions

Taper	Item Code	MHD' d1	L	Promo
M16	PR-16.25	M16	0.98	\$154.30
M20	PR-20.32	M20	1.26	\$154.30
M25	PR-25.25	M25	0.98	\$154.30
	PR-25.40		1.57	\$161.07
M32	PR-32.32	M32	1.26	\$161.07
	PR-32.50		1.97	\$169.19
M40	PR-40.40	M40	1.57	\$169.19
	PR-40.63		2.48	\$177.31
M50	PR-50.50	M50	1.97	\$177.31
	PR-50.80		3.15	\$192.20
	PR-50.100		3.94	\$205.73
M63	PR-63.63	M63	2.48	\$205.73
	PR-63.100		3.94	\$226.04
	PR-63.125		4.92	\$239.57
M80	PR-80.80	M80	3.15	\$288.30
	PR-80.125		4.92	\$318.07
	PR-80.160		6.30	\$337.02

Reducers

Item Code	MHD' d1	MHD' d2	L	L1	Promo
RD-20/16.20	M20	M16	0.79	0.63	\$151.59
RD-25/16.20	M25	M16	0.79	0.59	\$154.30
RD-25/20.25		M20	0.98	0.79	\$154.30
RD-32/16.24	M32	M16	0.94	0.71	\$161.07
RD-32/20.25		M20	0.98	0.79	\$161.07
RD-32/25.28		M25	1.10	0.91	\$161.07
RD-40/16.24	M40	M16	0.94	0.67	\$169.19
RD-40/20.26		M20	1.02	0.79	\$169.19
RD-40/25.28		M25	1.10	0.87	\$169.19
RD-40/32.32		M32	1.26	1.06	\$169.19
RD-50/16.24	M50	M16	0.94	0.59	\$178.66
RD-50/16.40			1.57	1.26	\$212.50
RD-50/16.74			2.91	2.56	\$239.57
RD-50/20.26		M20	1.02	0.71	\$178.66
RD-50/20.70			2.76	2.44	\$221.97
RD-50/20.93			3.66	3.35	\$250.40
RD-50/25.28		M25	1.10	0.83	\$178.66
RD-50/25.87			3.43	3.15	\$230.09
RD-50/25.117			4.61	4.33	\$257.16
RD-50/32.32		M32	1.26	0.98	\$188.14
RD-50/32.87			3.43	3.15	\$239.57
RD-50-32.144			5.67	5.39	\$267.99
RD-50/40.36	M40	1.42	1.18	\$188.14	
RD-50/40.87		3.43	3.15	\$250.40	
RD-50/40.176		6.93	6.69	\$274.76	
RD-63/50.40	M63	M50	1.57	1.34	\$197.61
RD-80/50.45	M80	M50	1.77	1.42	\$250.40
RD-80/63.60		M63	2.36	2.05	\$250.40

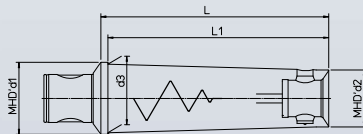

Reducers with Anti-Vibe Core

Item Code	MHD' d1	MHD' d2	d3	L	L1	Promo
RAV-50/16.74	M50	M16	0.69	2.91	2.56	\$353.27
RAV-50/20.93		M20	0.85	3.66	3.35	\$399.28
RAV-50/25.117		M25	1.06	4.61	4.33	\$506.21
RAV-50/32.144		M32	1.38	5.97	5.43	\$706.52
RAV-50/40.176		M40	1.85	6.93	6.69	\$1,104.45
RAV-63/50.220	M63	M50	2.36	8.66	8.43	\$1,947.68
RAV-80/63.280	M80	M63	3.03	11.02	10.71	\$3,972.50